

# L Series

## Miniature Slide Switches

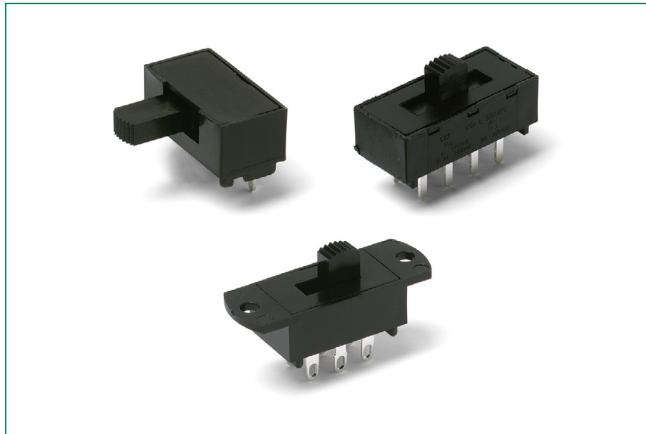

### Description

Those designing communications equipment and lighting devices turn to the L series miniature slide switch. L series switches feature positive detent, enclosed housing and your choice of maintained or momentary functions and PC or panel mounting.

### Features & Benefits

- Positive detent
- Enclosed housing
- Maintained and momentary functions
- PC and panel mounting
- RoHS compliant

### Applications

- Communications equipment
- Lighting devices

### Agency Approvals

Agency	Agency File Number
	E42363

### Specifications

<b>Contact Rating</b>	Q contact material (LX0X, LX1X models): 4 amps @ 125 V AC or 28 V DC; 2 amps @ 250 V AC; 0.5 amp @ 125 V DC (UL).
<b>Electrical Life</b>	10,000 make-and-break cycles at full load.
<b>Contact Resistance</b>	Below 10 m Ω typ. initial @ 2-4 V DC, 100 mA, for both silver and gold plated contacts.
<b>Insulation Resistance</b>	10 <sup>9</sup> Ω min.
<b>Dielectric Strength</b>	1,000 Vrms min. @ sea level.
<b>Operating Temperature</b>	-30°C to 65°C
<b>Storage Temperature</b>	-30°C to 85°C

### Materials

<b>Housing</b>	6/6 nylon (UL94-V2), black.
<b>Actuator</b>	6/6 nylon (UL94-V2), black. '13' actuator, natural (standard).
<b>Contacts</b>	Q contact material: Copper, silver plated.
<b>Terminals</b>	
<b>Contact Spring</b>	Music wire or stainless steel.
<b>Terminal Seal</b>	Epoxy.

**Notes:**

Specifications and materials listed above are for switches with standard options. For information on specific and custom switches, consult Customer Service Center.

### Ordering Number

Our easy build-a-switch concept allows you to mix and match options to create the switch you need. To order, select desired option from each category and place it in the appropriate box.

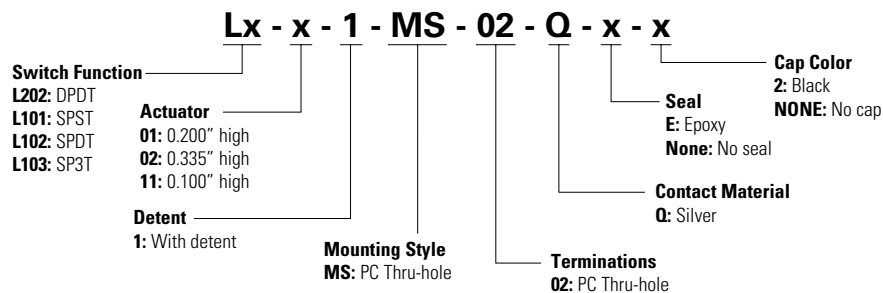

# L Series

## Miniature Slide Switches



### Switch and Lock Function

No. Poles	Model No.	Switch Function	Schematic	Available Mounting Styles
SP	L101	SPST		MS
	L102	SPDT		
	L103	SP3T		

No. Poles	Model No.	Switch Function	Schematic	Available Mounting Styles
DP	L202	DPDT		MS

Notes: Contacts make on side actuator thrown.

### Actuator

#### Actuator Options for MS Mounting Style

01 0.200" High

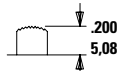

02 0.335" High

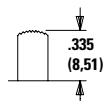

03 0.375" High

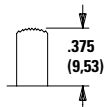

05 0.312" High

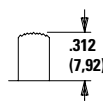

11 0.100" High



12 Screwdriver Slot

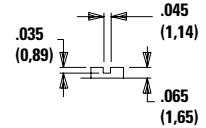

Notes: No actuator color option code is required. Standard actuator color is black, other colors and heights available, consult Customer Service Center.

Option Code	Actuator Cap Colors
2	Black for 01 and 02 actuators
None	No cap

### Detent

#### 1 With Detent

Standard with all maintained models: L101, L102, L103, L104, L113, L201, L202, L203 and L204.

### Mounting Styles

#### MS PC Thru-hole, 2 Position Models L203011MS02Q DP3T

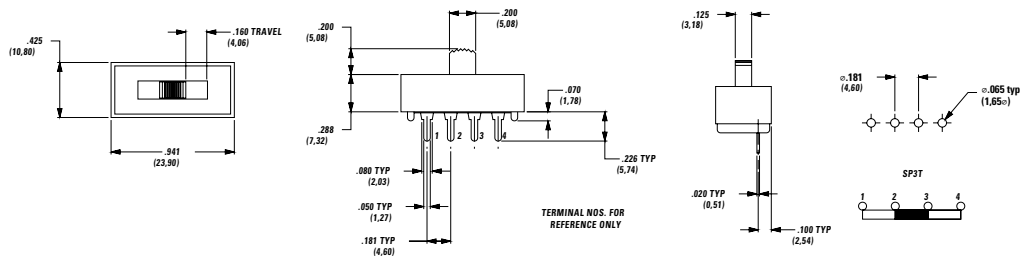

Available with:  
**Models:** L101, L112, L103 and L202  
**Terminations:** 02  
**Actuators:** 01, 02 and 11  
**PC Mounting:** 02

# L Series

## Miniature Slide Switches



### Terminations inches (mm) MS Mounting Style 02 PC Thru-hole

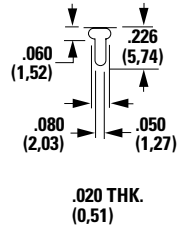

### MA & ML Mounting Styles Only

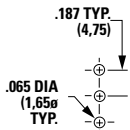

All models with '04' terminations and 'ML' mounting style.

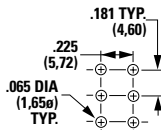

All 2 position models, except '04' and '10' terminations.

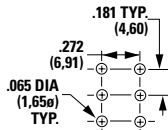

All 2 position models with '04' and '10' terminations.

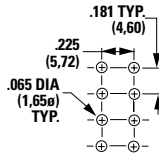

All 3 position models, except '04' and '10' terminations.

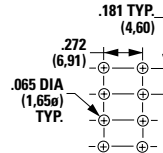

All 3 position models, with '10' termination.

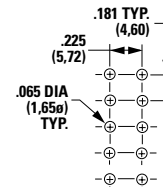

All 4 position models, except '04' and '10' terminations.

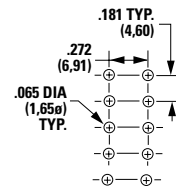

All 4 position models, with '10' terminations.

### Contact Material

Option Code	Contact Material	Power	Ratings
Q	Silver	Power	LX0X models: 4 amps @ 125 V AC or 28 V DC; 2 amps @ 250 V AC; 0.5 amp @ 125 V DC (UL). LX6X models: 4 amps @ 125 V AC or 28 V DC; 2 amps @ 250 V AC(UL).

### Seal

#### None No Seal

#### E Epoxy Seal

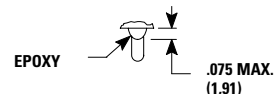

### Cap Compatible with 02 actuators

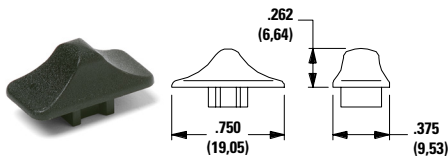

Part No.  
120100602 Black  
Material: Nylon  
Finish: Matte

Notes: Other colors available, consult Customer Service Center.

**Disclaimer Notice** - Information furnished is believed to be accurate and reliable. However, users should independently evaluate the suitability of and test each product selected for their own applications. Littelfuse products are not designed for, and may not be used in, all applications. Read complete Disclaimer Notice at <http://www.littelfuse.com/disclaimer-electronics>.